

CITY OF SHOREWOOD

5755 Country Club Road • Shorewood, Minnesota 55331 • 952-960-7900
Fax: 952-474-0128 • www.ci.shorewood.mn.us • cityhall@ci.shorewood.mn.us

MEMORANDUM

TO: Planning Commission, Mayor and City Council

FROM: Marie Darling, Planning Director

REVIEWED BY: Patti Helgesen, Planning Assistant

MEETING DATE: January 15, 2019

RE: **Tower Engineering Professionals** – C.U.P. for collocation of telecommunication antennas on the existing tower

LOCATION: **24283 Smithtown Road**

ZONING: C-1

FILE NO.: 18.23

The applicant has requested additional time to complete the final details of their application. Because the public hearing was advertised and the notices to adjacent neighbors have been sent out, staff request that the Planning Commission open the public hearing, take any public testimony and continue the application to the February 5, 2019 meeting. At that time, staff would make a full presentation of the application and staff's recommendation.

REQUEST

The applicant, on behalf of Dish Wireless, proposes to add three telecommunication antennas, eight radio receiving units (RRUs), and various other equipment with a new triangular array on the existing tower. They would also add a new cabinet and equipment on a new equipment platform within the existing fenced area at the base of the tower.

Notice of this application was published in both the City's official newspapers and mailed to all property owners within 500 feet of the property at least 10 days prior to the meeting.

ATTACHMENTS:

Location Map
Site Plan



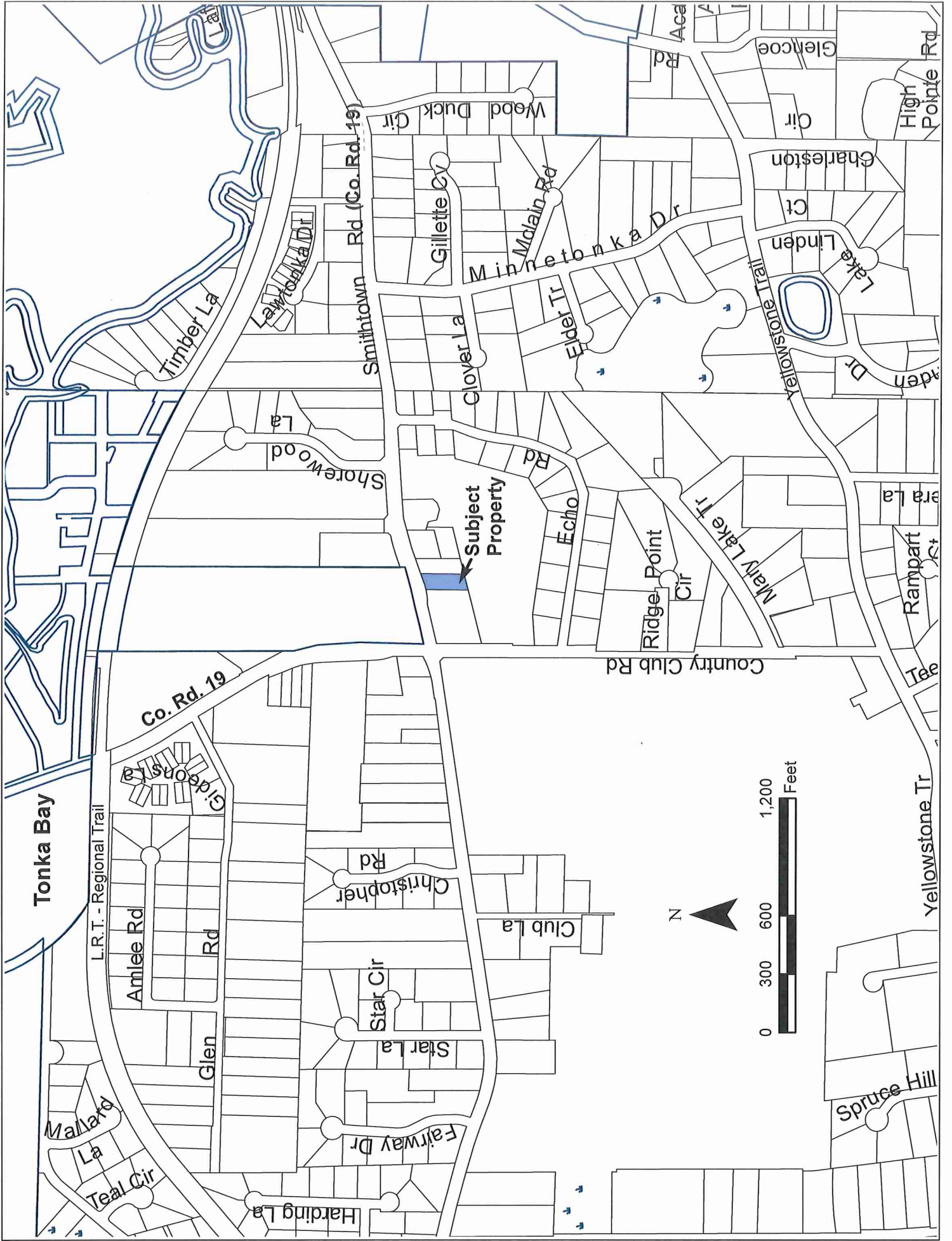



PREPARED FOR:
dish WIRELESS

PREPARED BY:
 TOWER ENGINEERING PROFESSIONALS
 525 HENNING ROAD
 MINNETONKA, MN 55345
 OFFICE: (952) 836-6361
 www.teppro.com

Print Name: SAHANN M. ANDRES
 Signature: [Signature]
 Date: 12/18/18
 License # 51950

I hereby certify that this plan, specification, or report was prepared by me or under my direct supervision and that I am a duly Licensed Professional Engineer under the laws of the State of Minnesota.

DRAWN BY: JHU
 CHECKED BY: CP
 APPROVED: CSN

DATE	DESCRIPTION	REV	ISSUED BY
11-28-18	PRELIMINARY	0	CP
11-30-18	CONSTRUCTION	1	CP
12-27-18	CONSTRUCTION	2	CP

THESE DOCUMENTS ARE THE PROPERTY OF TOWER ENGINEERING PROFESSIONALS. ANY REPRODUCTION OR CIRCULATION OF THESE DOCUMENTS WITHOUT THE PERMISSION OF TOWER ENGINEERING PROFESSIONALS IS PROHIBITED.

TEP NUMBER: 143982
 DISH WIRELESS SITE ID: MN1070009A
 TOWER OWNER SITE ID: 81418
 SITE ADDRESS:
 24283 SMITHTOWN ROAD
 EXCELSIOR, MN 55331
 (HENNING COUNTY)

SHEET TITLE:
COMPOUND PLAN

SHEET NUMBER:
C-1

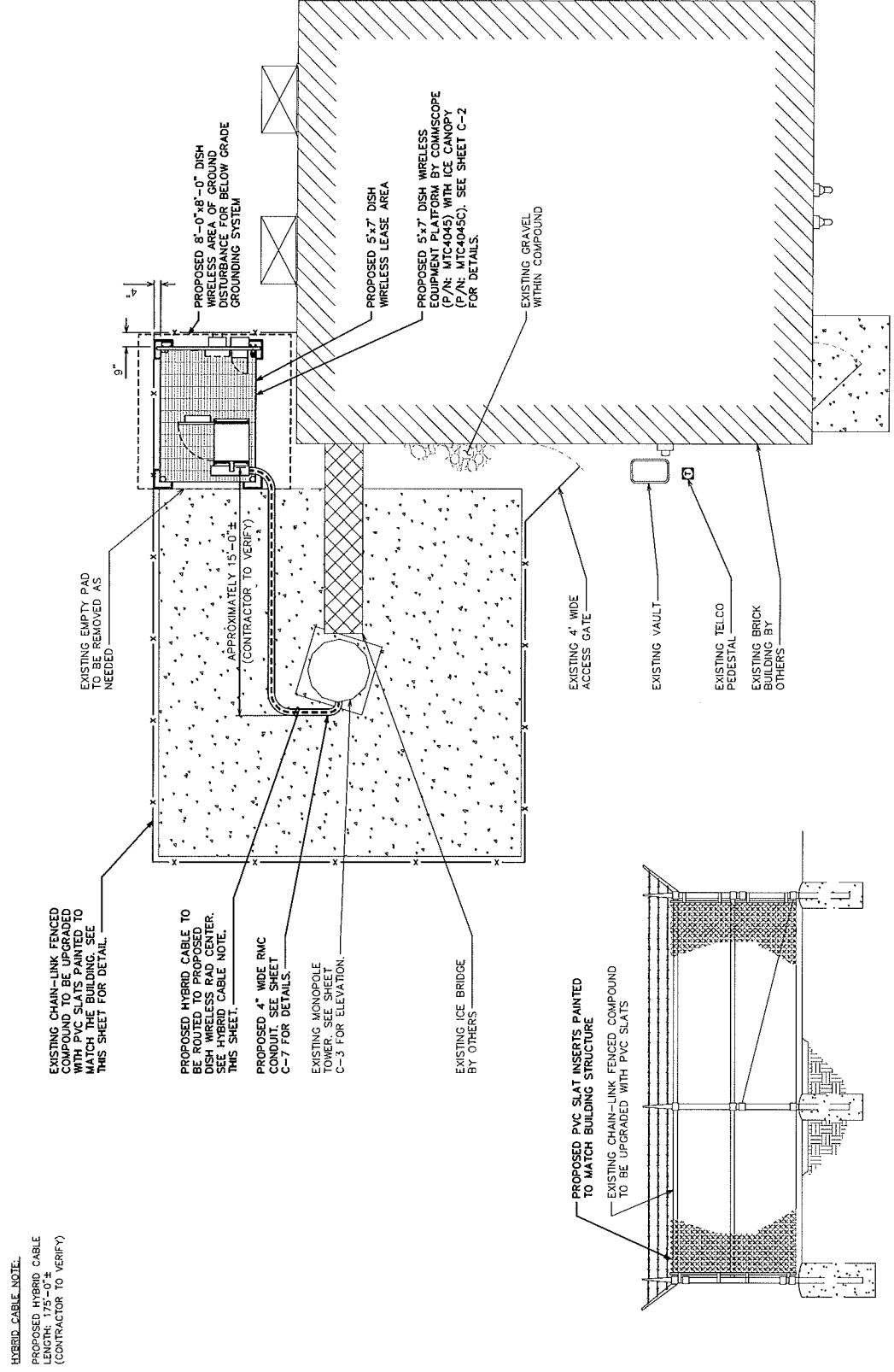

NOTES:
 1. ALL SITE INFORMATION HAS BEEN PROVIDED BY THE CLIENT. TEP IS NOT LIABLE AND DOES NOT ASSUME RESPONSIBILITY FOR THIS CONTENT.
 2. PROPOSED SATELLITE DISH LOCATION TO BE VERIFIED IN THE FIELD AT TIME OF CONSTRUCTION.

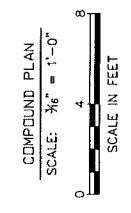

COMPOUND FENCE UPGRADE
 SCALE: N.T.S.

